

12 VOLT

DUCATI GP

Peg-Pérego

made in italy

cod. IGMC0020

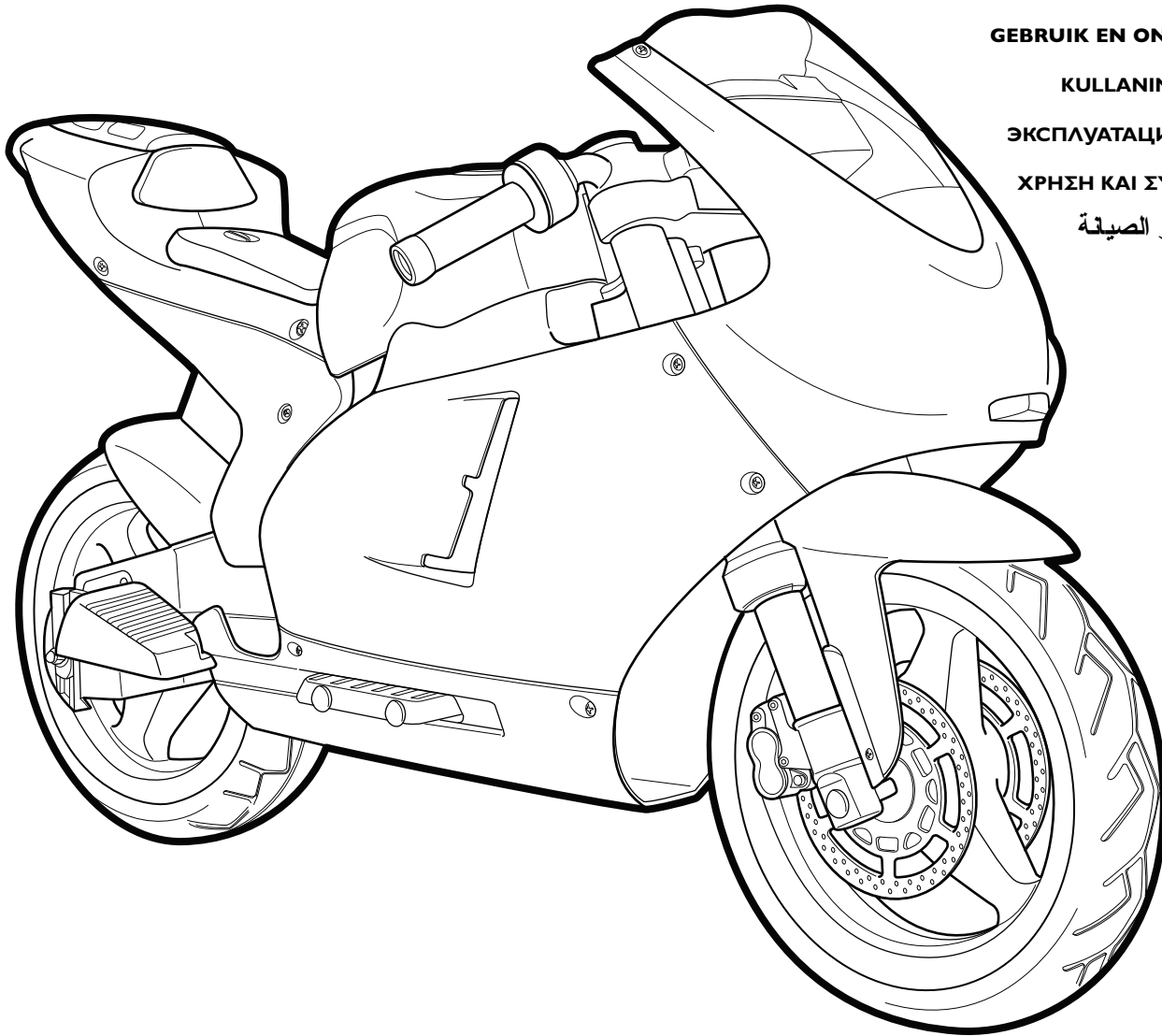

USO E MANUTENZIONE **IT**

USE AND CARE **EN**

UTILISATION ET ENTRETIEN **FR**

GEBRAUCH UND WARTUNG **DE**

EMPLEO Y MANUTENCION **ES**

USO E MANUTENÇÃO **PT**

UPORABA IN VZDRŽEVANJE **SL**

BRUGSANVISNING **DA**

KÄYTTÖOHJE **FI**

BRUKSANVISNING **NO**

BRUKSANVISNING **SV**

GEbruik EN ONDERHOUD **NL**

KULLANIM VE BAKIM **TR**

ЭКСПЛУАТАЦИЯ И УХОД **RU**

ΧΡΗΣΗ ΚΑΙ ΣΥΝΤΗΡΗΣΗ **EL**

الاستخدام و الصيانة **AR**



0005



FI00180IGI26



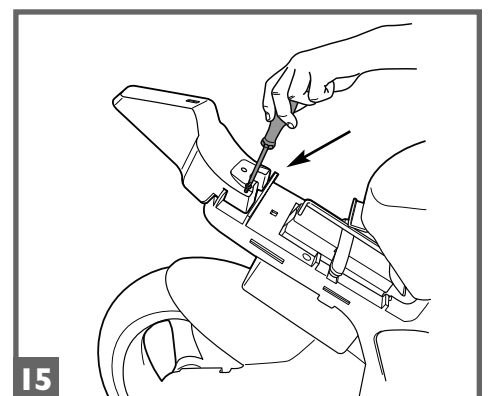
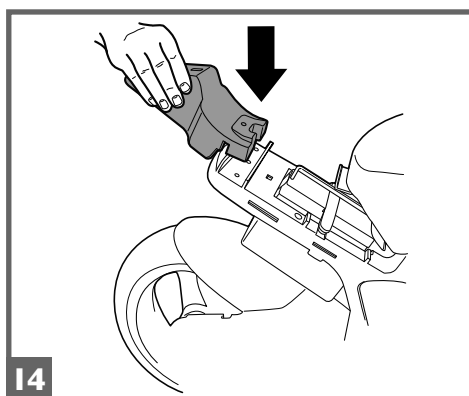
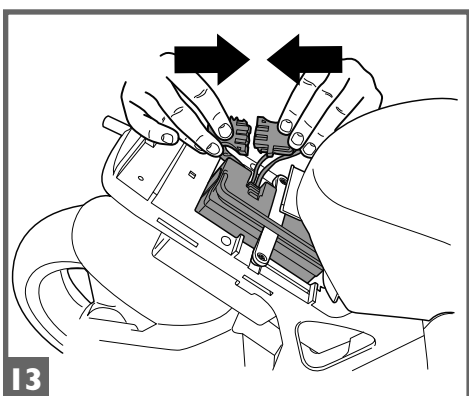
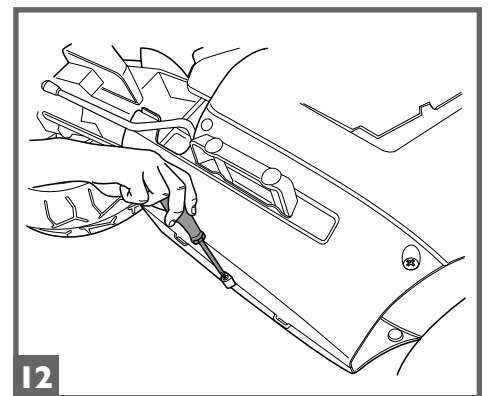
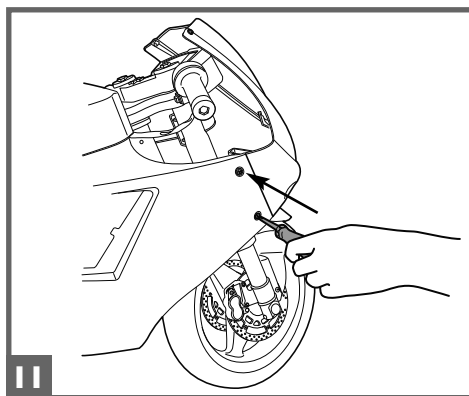
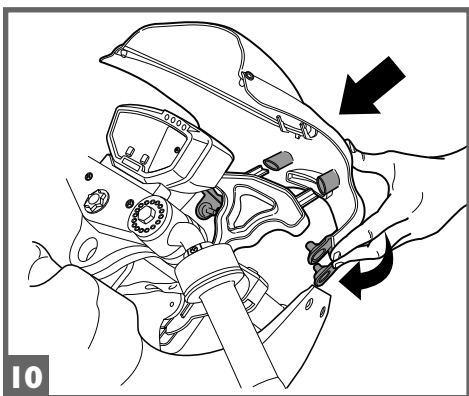
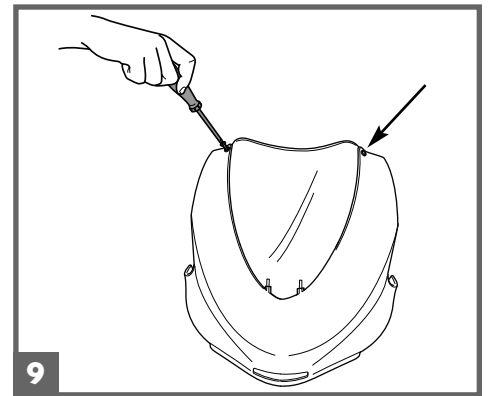
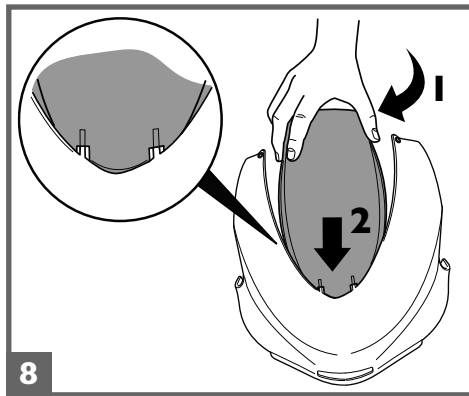
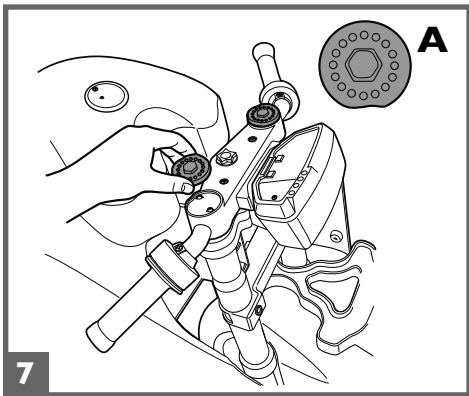
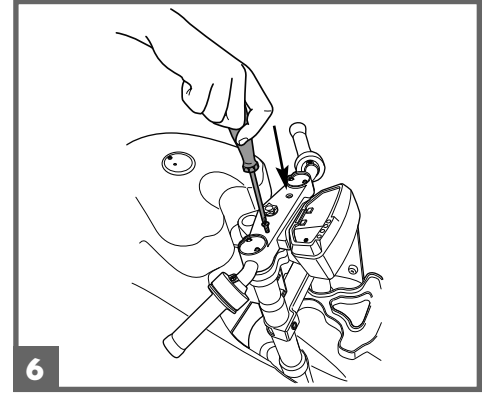
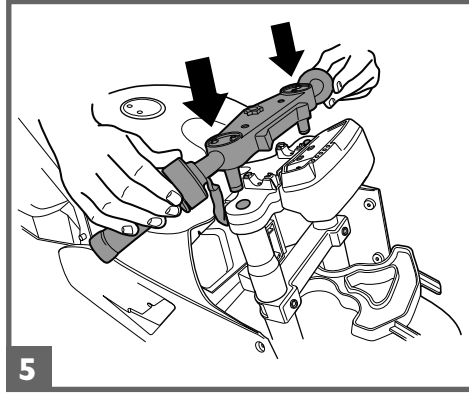
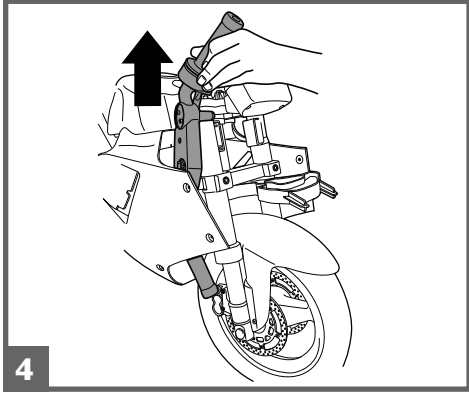
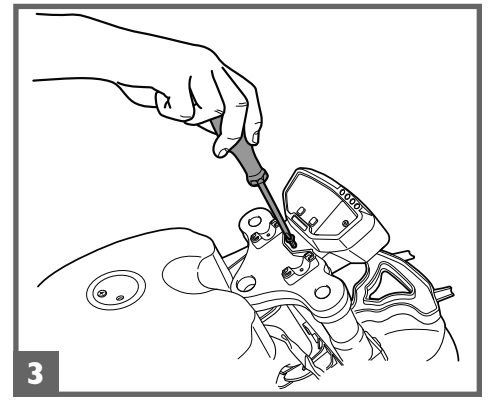
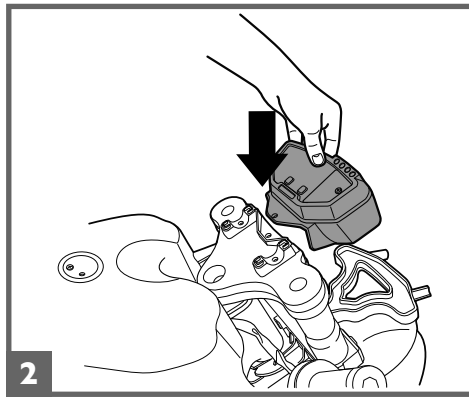
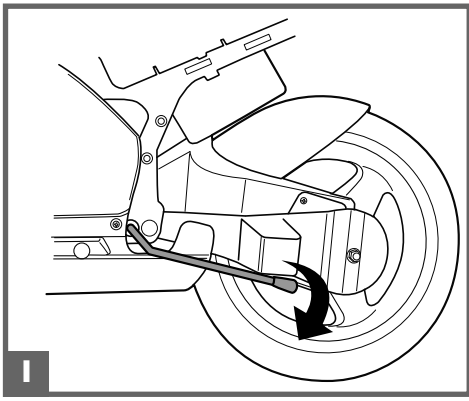

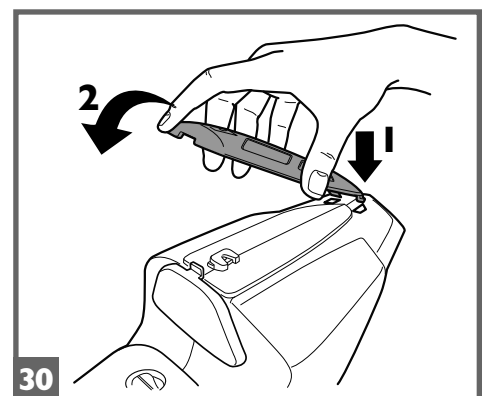
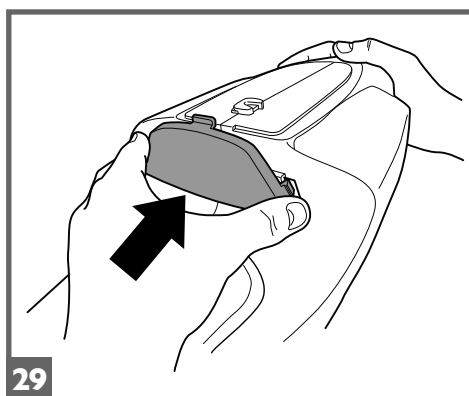
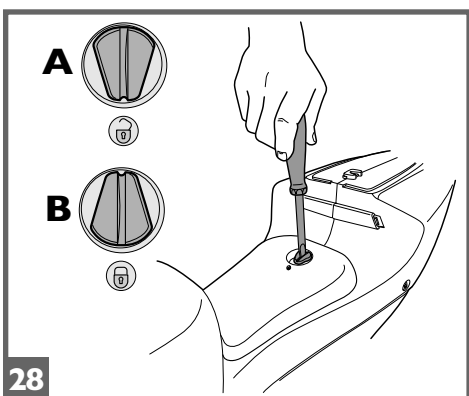
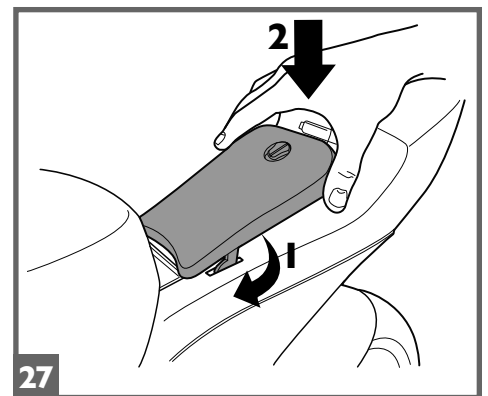
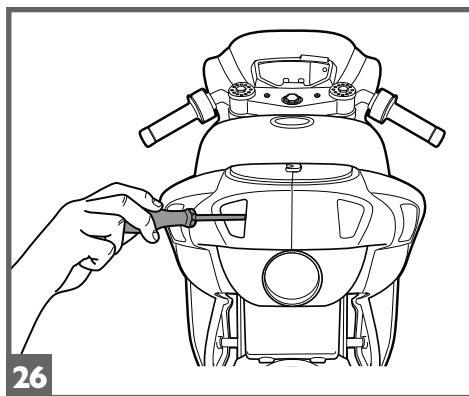
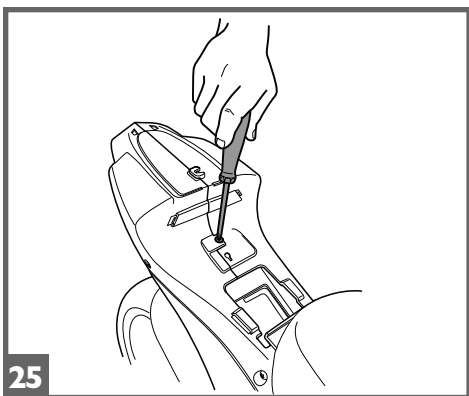
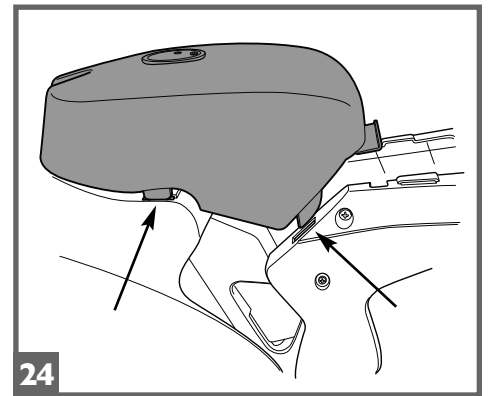
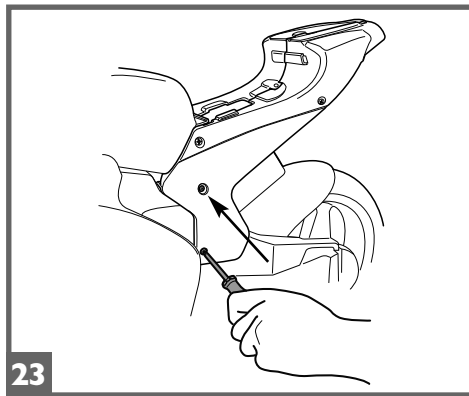
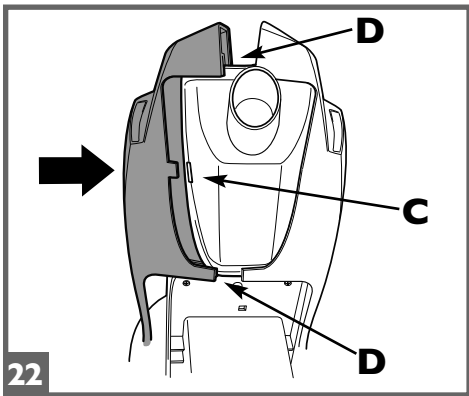
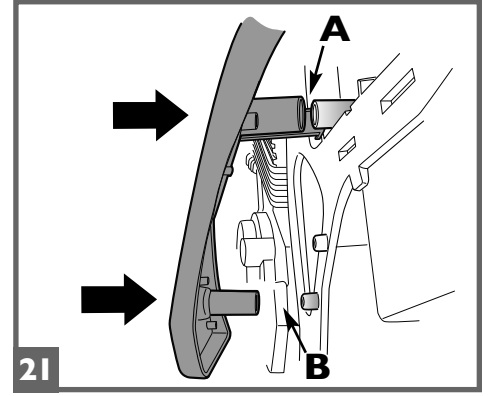
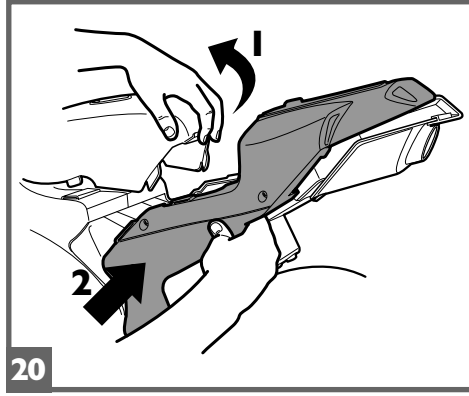
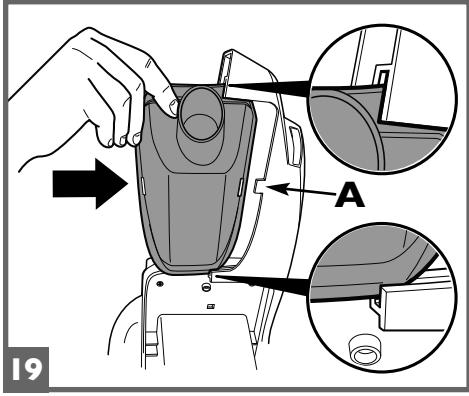
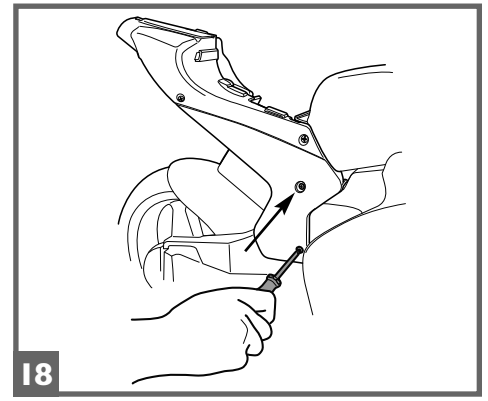
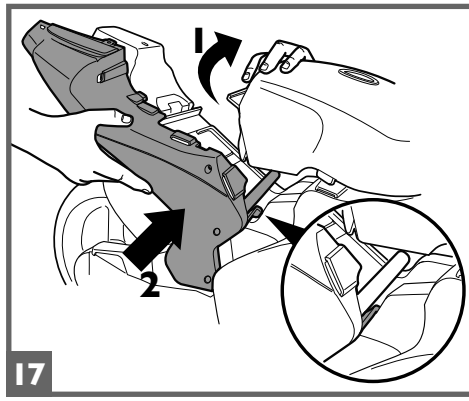
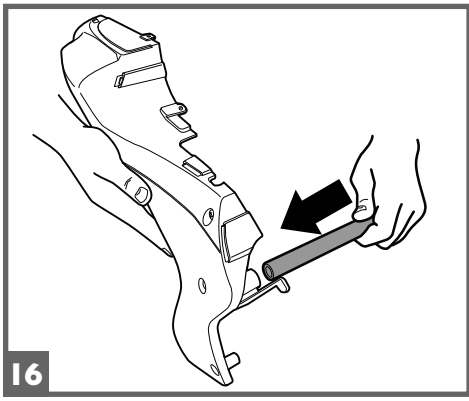

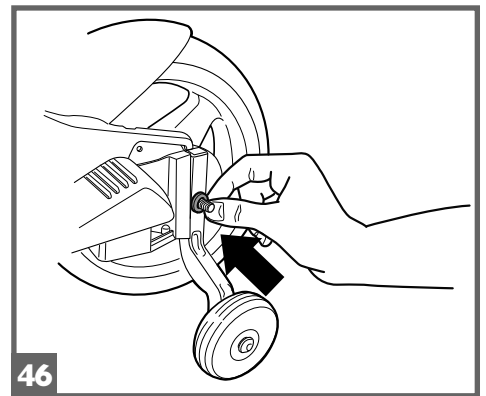
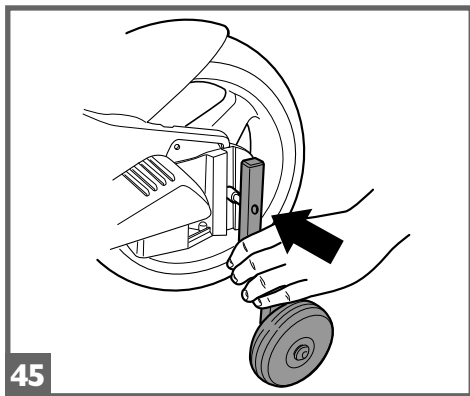
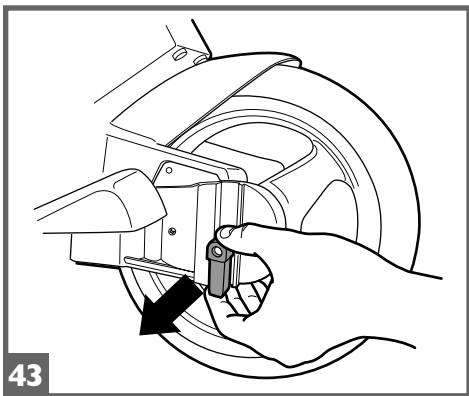
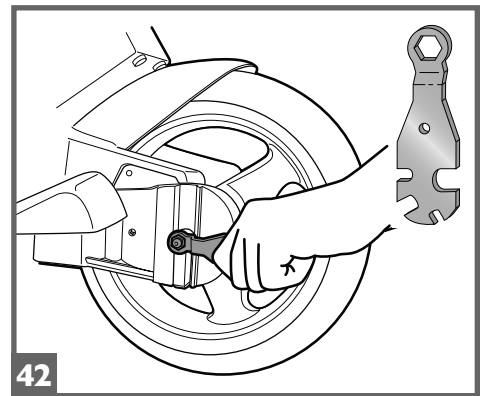
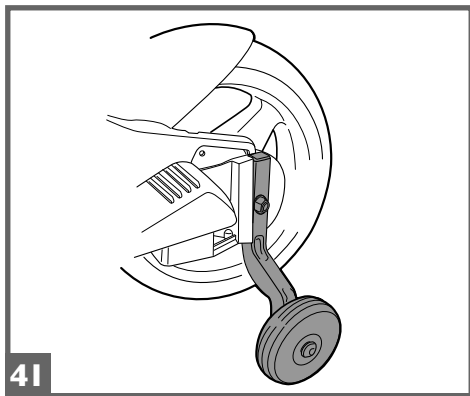
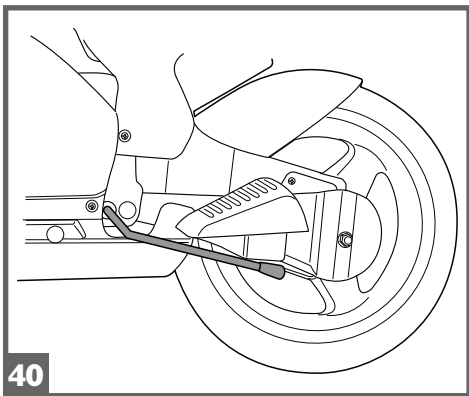
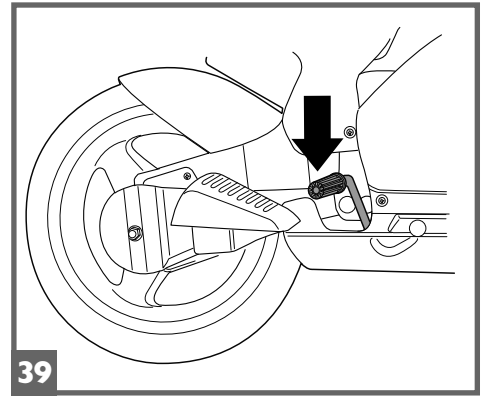
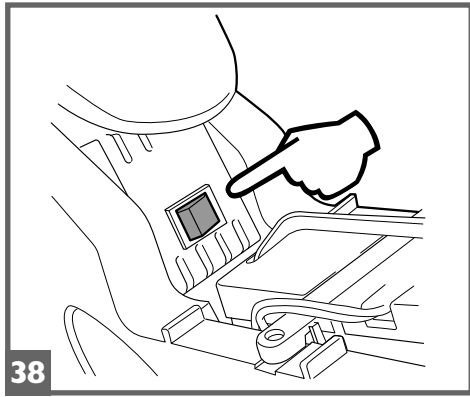
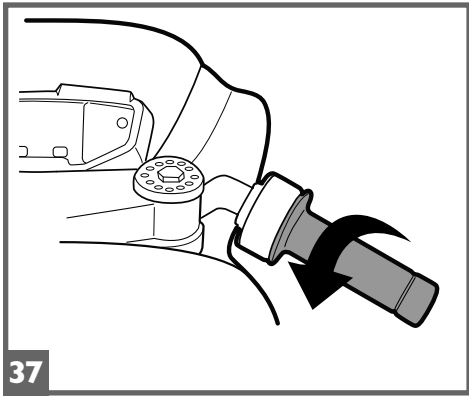
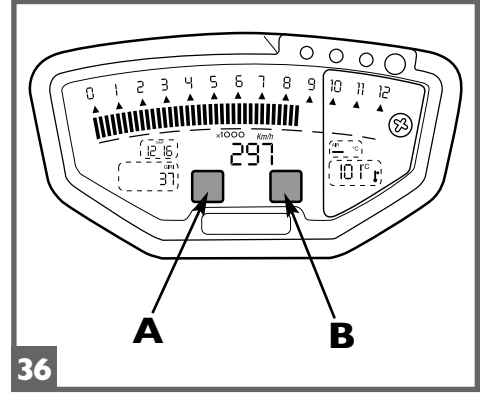
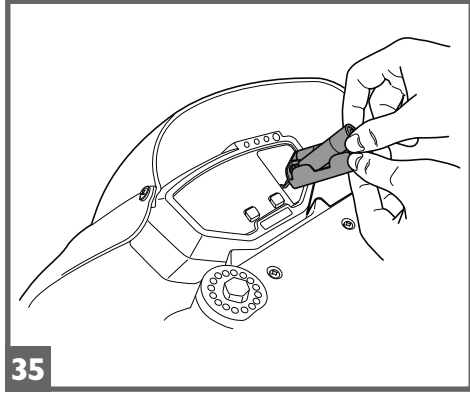
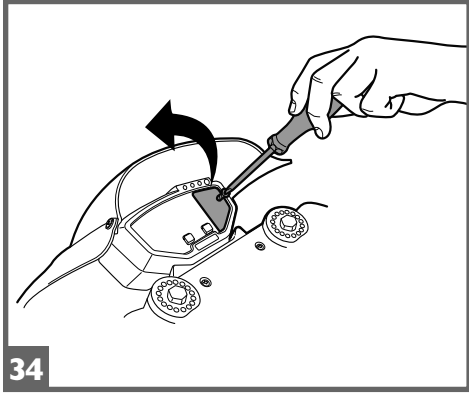
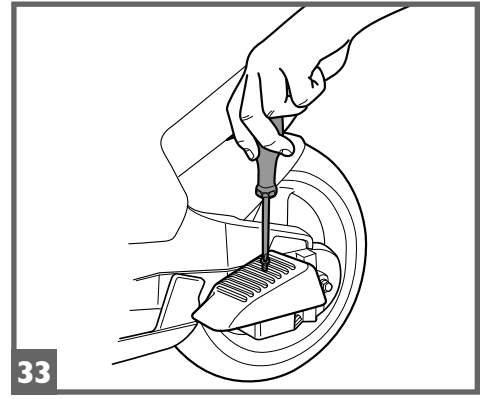
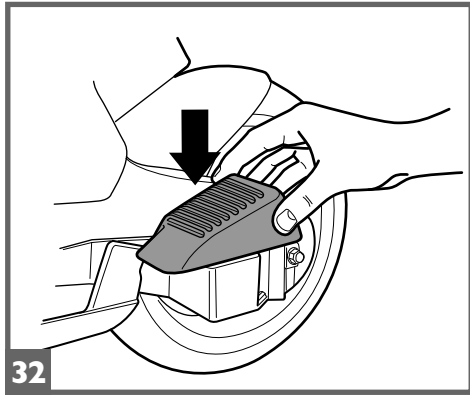
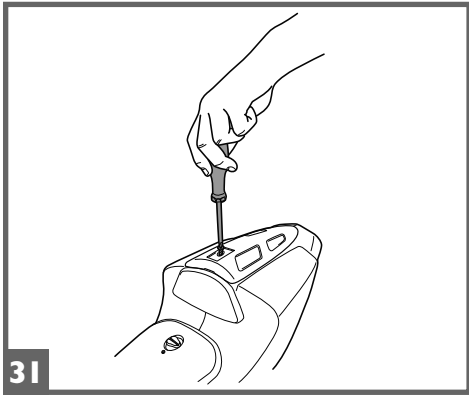

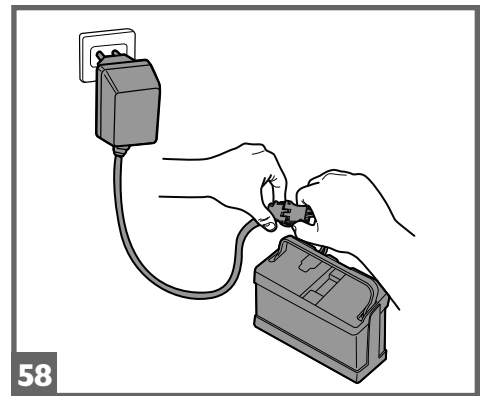
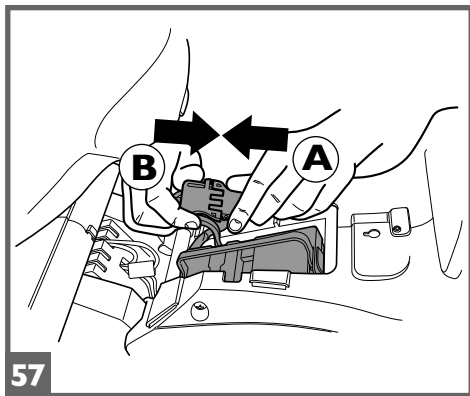
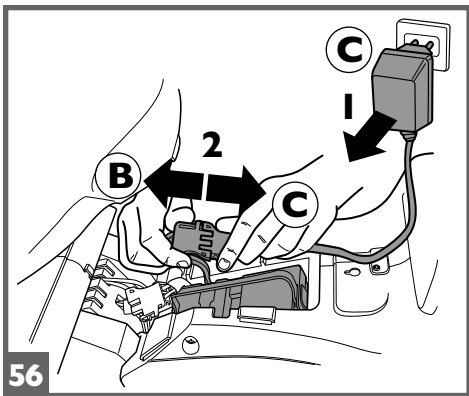
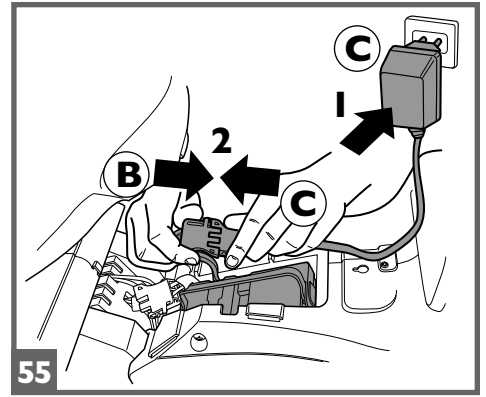
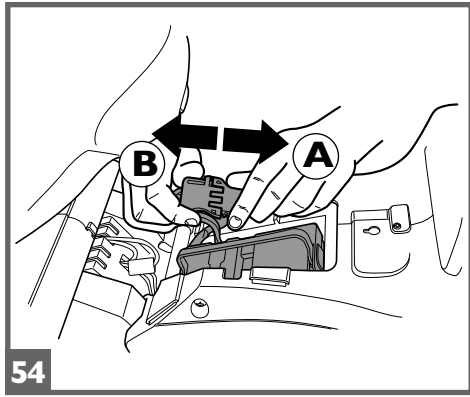
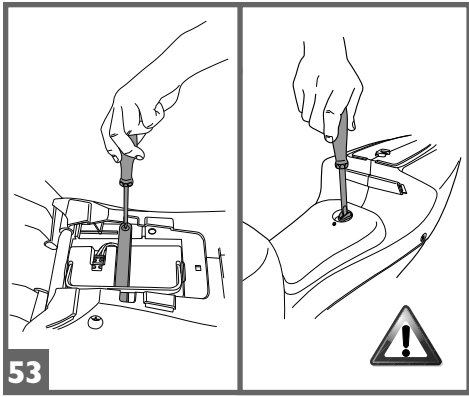
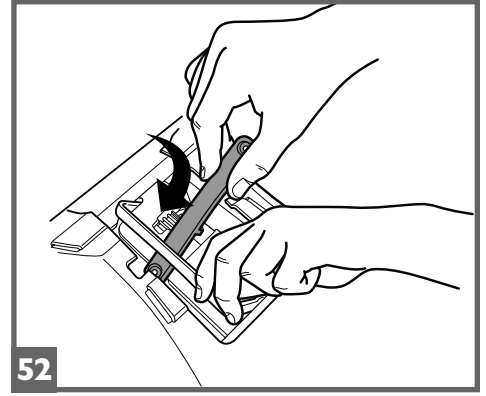
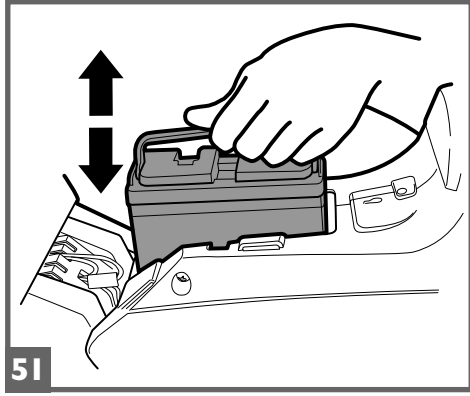
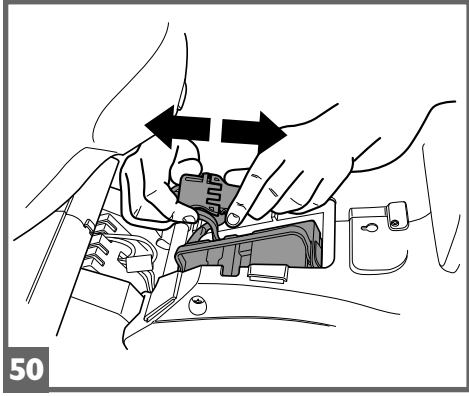
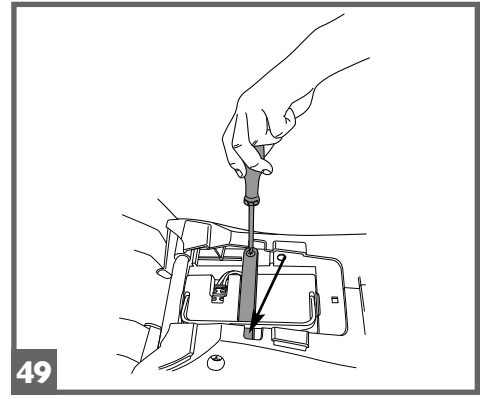
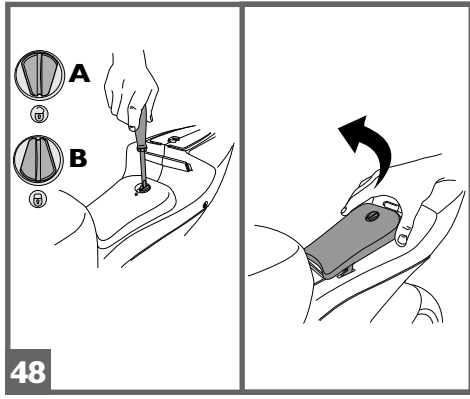
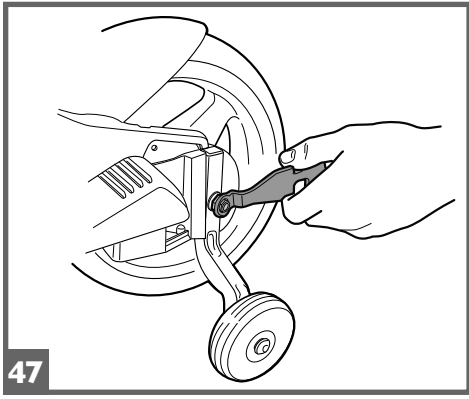

INSERIMENTO PILE

- 34 • Svitare la vite sul cruscotto e togliere lo sportellino.
- 35 • Estrarre il portatile. Inserire due pile AA da 1,5V rispettando la polarità.
 - Riposizionare il portatile all'interno del cruscotto e richiudere lo sportellino fissandolo con la vite.

CARATTERISTICHE E USO DEL VEICOLO

- 36 • **CRUSCOTTO CON SUONI:** premere i tasti per azionare i suoni.
 - A: clacson
 - B: rombo motore DUCATI
- 37 • **MANUBRIO:** Manopola acceleratore. Ruotare la manopola verso il basso per far partire la moto. Ruotandola verso l'alto la moto decellerà.
- 38 • **SECONDA VELOCITÀ:** quando si estrae il veicolo dall'imballo, questo è settato per viaggiare alla velocità più bassa (**PRIMA VELOCITÀ**) per consentire al bambino di acquisire dimestichezza con la moto. Per far viaggiare il veicolo ad una velocità più alta (**SECONDA VELOCITÀ**) agire sul pulsante collocato sotto la sella, alzando il serbatoio. **ATTENZIONE** Si sconsiglia di utilizzare la 2ª velocità con le ruote stabilizzatrici montate per non incorrere nel pericolo di ribaltamento in curva.
- 39 • **PEDALE FRENO:** per frenare la moto abbassare il pedale del freno con un piede.
- 40 • **CAVALLETTO:** usare quando la moto è sprovvista di ruote stabilizzatrici.
- 41 • **RUOTE STABILIZZATRICI:** usare se il bambino ha scarso equilibrio. **ATTENZIONE** Si sconsiglia di utilizzare la 2ª velocità con le ruote stabilizzatrici montate per non incorrere nel pericolo di ribaltamento in curva. Per montare le ruote stabilizzatrici seguire le istruzioni delle figure 42-46.
- 42 • Per montare le ruote stabilizzatrici svitare il dado di bloccaggio della ruota posteriore con la chiave in dotazione. Estrarre il dado e la rondella e conservarli per fissare la ruota stabilizzatrice.
- 43 • Sfilare il distanziale e conservarlo per un futuro quando il bambino userà la moto senza le ruote stabilizzatrici.
- 44 • Inserire la ruota stabilizzatrice sull'assale della ruota.
- 45 • Inserire la rondella tolta in precedenza.
- 46 • Riavvitare il dado di fissaggio della ruota. Ripetere le operazioni di montaggio dall'altro lato per montare l'altra ruota stabilizzatrice.

SOSTITUZIONE DELLA BATTERIA

- 47 • Per sostituire la batteria scarica, ruotare il fermo di bloccaggio della sella nella posizione A. Togliere la sella.
- 48 • Svitare le due viti del fermabatteria ed estrarlo.
- 49 • Scollegare la spina della batteria da quella dell'impianto elettrico.
- 50 • Sostituire la batteria e ricollegare le spine.
- 51 • Riposizionare il fermabatteria facendolo passare sotto la maniglia della batteria.
- 52 • Fissare il fermabatteria con le due viti, riposizionare la sella e fissarla ruotando il fermo. **ATTENZIONE:** fissare sempre il fermabatteria e la sella prima di utilizzare la moto.

CARICA DELLA BATTERIA

ATTENZIONE: LA CARICA DELLA BATTERIA E QUALSIASI INTERVENTO ALL'IMPIANTO ELETTRICO DEVONO ESSERE EFFETTUATI DA ADULTI.

LA BATTERIA PUÓ ESSERE CARICATA ANCHE SENZA RIMUOVERLA DAL GIOCO.

- 53 • Scollegare la spina A dell' impianto elettrico dalla spina B della batteria premendo le spine lateralmente.
- 54 • Inserire la spina del caricabatterie ad una presa domestica seguendo le sue istruzioni allegate al caricabatterie. Collegare la spina B della batteria con la spina C del caricabatterie.
- 55 • A carica ultimata staccare il caricabatteria dalla presa domestica, poi scollegare la spina C dalla spina B.
- 56 • Inserire a fondo, fino allo scatto, la spina B nella spina A.
 - **ATTENZIONE:** terminate le operazioni di ricarica fissare sempre la sella ruotando il fermo.
- 57 • La batteria può essere caricata anche fuori dal veicolo in questo modo se avete una batteria di scorta, il bambino può continuare a giocare.

ENGLISH

Thank you for choosing a PEG PEREGO® product. For over 60 years PEG PEREGO have been with you as you take your children out - in carriages just after they are born, then in strollers, and later on in pedal and battery-powered toys

Discover our complete range of products, news and other information about the Peg Perego world on our web site.

www.pegperego.com



Peg Perego S.p.A. is ISO 9001 certified.

This certification provides customers and consumers with a guarantee of transparency and assurance about the company's working procedures.

IMPORTANT INFORMATION

Read this instruction manual carefully to learn how to use the vehicle and teach your child to drive it properly and safely while enjoying it at the same time. Keep the manual safe for future reference.

If you transfer this product to another user, make sure to include this instructions booklet.

Before using the vehicle for the first time, charge the battery for 18 hours. Failure to do this could result in irreparable damage to the battery.

- **Ages 3+**
- **Maximum allowable weight 30 kg**
- One-seat vehicle
- One 12V 8Ah sealed lead acid rechargeable battery
- One drive wheel
- Two 165 V motors
- Speed in 1st gear 3,8 km/h - 2.3 MPH
- Speed in 2nd gear 7,6 km/h - 4.7 MPH

Do not exceed the maximum allowable weight of 30 kg. This limit includes both the occupant and the load (if any).

Peg Perego reserve the right to make changes to the models and information in the present publication at any time, for technical or company reasons.

DECLARATION OF CONFORMITY

A CE marked product, designed and type-approved in compliance with the applicable EU directives, intended for the markets and countries implementing such standards.

PRODUCT NAME

Ducati GP

PRODUCT IDENTIFICATION CODE

IGMC0020

REFERENCE STANDARD (origin)

Directive on the safety of toys 2009/48/EC
Standard EN 71-1 + EN 71-2
Standard EN 71-3
Standard EN 62115

Directive on the electromagnetic compatibility 1999/5/CE or RED 2014/53/UE
Standard EN 55014
Standard EN 55022
Standard EN 61000

Information:

Directive on WEEE - RAEE 2003/108/EC
Directive on batteries and accumulator 2008/103/EC
Directive on RoHS 2011/65/UE - EN 50581:2012
Reg. (CE) n.1907/2006 (Reach) allegato XVII-51 &52
phthalates in toys

The vehicle is not compliant with the requirements of road transport standards and consequently cannot travel on public roads.

DECLARATION of CONFORMITY

Peg Perego S.p.A. declares under its own responsibility that the item in question has been subjected to internal operational tests and approved according to the standards in force at external, independent laboratories.

PLACE AND DATE OF ISSUE

Italy - 10.05.2013

Peg Perego S.p.A.
via A. De Gasperi 50
20862 Arcore (MB) - ITALIA

SAFETY STANDARDS

Our toys are compliant with European Safety Standards for toys (safety requirements stipulated by the EEC Council) and with the "U.S. Consumer Toy Safety Specification". They are also certified by notified toy safety bodies in accordance with Directive 2009/48/EC. They are not compliant with the requirements of road transport standards and consequently cannot travel on public roads.

- **WARNING.** This toy is unsuitable for children under 3 years due to its maximum speed.
- **WARNING!** Not suitable for children under the age of 36 months. The small parts may be swallowed or inhaled, leading to suffocation.
- **WARNING! DO NOT, UNDER ANY CIRCUMSTANCE,** use this toy on public roads.
- **WARNING!** Using the vehicle on public roads, in narrow spaces or near watercourses and swimming pools may cause injury to the users and/or third parties. Adult supervision is always necessary.
- Children must always wear shoes when using the vehicle.
- When the vehicle is in operation make sure that children do not put their hands, feet, other body parts, clothing, or other objects close to the moving parts.
- Never wet sensitive vehicle components like the motors, electrical systems, buttons, etc.
- Do not use petrol or other flammable substances close to the vehicle.
- The vehicle must be only be used by a single child unless it is classed as a two-seater vehicle.

WEEE DIRECTIVE (EU only)

- At the end of its useful life, this product is classed as Waste Electrical and Electronic Equipment (WEEE) and must therefore not be disposed of as urban waste but instead taken to a designated separated waste collection facility.
- Take it to an appropriate collection centre.
- The presence of dangerous substances contained in the electrical components of this product represents a potential source of danger to human health and for the environment if the products are not disposed of correctly.
- The barred dustbin symbol indicates that the product must undergo sorted waste collection.



DISPOSAL OF THE BATTERY

- Help protect the environment.
- Used batteries must not be disposed of with domestic waste.
- They can be left at a used battery or special waste collection centre. Contact your local authorities for more information.



AA 1.5 VOLT BATTERY WARNINGS

The insertion of the batteries must be carried out and supervised by adults only. Do not allow children to play with the batteries.

- The batteries must be replaced by an adult.
- Only use the battery type specified by the manufacturer.
- Respect the +/- polarity.
- Do not short circuit the power supply terminals: risk of fire or explosion.
- Always remove the batteries when the toy is not used for a long time.
- Do not throw the batteries into a fire.
- Never try to recharge batteries if they are not rechargeable.
- Do not mix old and new batteries.
- Remove flat batteries.
- Dispose of flat batteries in the appropriate recycling containers.



BATTERY WARNINGS

Battery charging must be carried out and supervised by adults only.

Do not allow children to play with the battery.

CHARGING THE BATTERY

- Charge the battery according to the instructions enclosed with the battery charger and never for more than 24 hours.
- To avoid damage, the battery should be charged as soon as the vehicle starts to lose speed.
- If the vehicle is left unused for a long time, remember to charge the battery and to keep it disconnected from the electrical system. Repeat the recharge procedure at least once every three months.
- The battery must not be charged upside-down.
- Do not forget about the battery which is being charged! Check it from time to time.
- Only use the battery charger provided and the original PEG PEREGO battery.
- The battery is sealed and does not require maintenance.
- Do not remove the battery charger from the socket by pulling the cable.
- Do not move the toy by pulling the battery charger cable.
- Do not cover the battery charger cable, as this would cause it to overheat.
- Do not place the cable and/or battery on hot surfaces.
- Take care on how and where you wrap the cable to so as not to damage it or compromise its operation.

WARNING

- **THE BATTERY CONTAINS CORROSIVE TOXIC SUBSTANCES. DO NOT TAMPER WITH IT.**
- The battery contains acid-based electrolytes.
- Do not create direct contact between the battery terminals, avoid strong impacts: risk of explosion and/or fire.
- While charging, the battery produces gas. Charge the battery in a well-ventilated environment, away from sources of heat and flammable materials.
- The flat battery must be removed from the vehicle.
- It is not advisable to bring the battery into contact with clothes, as it could damage them.
- Only use batteries or accumulators of the recommended kind.

IF THERE IS A BATTERY LEAK

Protect your eyes. Avoid direct contact with the electrolyte. Protect your hands. Put the battery in a plastic bag and follow the instructions for battery disposal.

IF SKIN OR EYES COME INTO CONTACT WITH THE ELECTROLYTE

Thoroughly rinse the area concerned with running water. Consult a doctor immediately.

IF THE ELECTROLYTE IS SWALLOWED

Rinse the mouth and spit out the water. Consult a doctor immediately.

MAINTENANCE AND VEHICLE CARE

- Do not disassemble or try to repair the vehicle on your own. Contact an authorised Peg Perego customer support centre.
- The toy should not be left anywhere with a temperature below 0°C. If it were to be used without being warmed up to a temperature above 0°C, irreversible damage could be caused to the motors and batteries.
- Check the condition of the vehicle regularly, paying particular attention to the electrical system, the plug connections, the terminal protectors and the battery charger. If defects are identified, the electrical vehicle and the battery charger must not be used.
- Always disconnect the battery charger from the toy before carrying out cleaning, maintenance, or any type of intervention.
- For repairs use only original PEG PEREGO spare parts.
- PEG PEREGO do not accept any responsibility for cases of tampering with the electrical system.
- Do not leave the batteries or the vehicle close to sources of heat like radiators, fireplaces, etc.
- Protect the vehicle from water, rain, snow, etc.

Using the vehicle on sand or mud may damage the buttons, motors and gears.

- Lubricate moving parts like bearings, steering, etc. periodically with light oil.
- The vehicle surfaces can be cleaned with a damp cloth and, if necessary, with non-abrasive domestic cleaning products.
- Cleaning must only be carried out by adults.
- Never dismantle the vehicle mechanisms or motors, unless authorized by PEG PEREGO.

RULES FOR SAFE DRIVING

For the safety of the child, before starting up the vehicle read and carefully follow the following instructions.

- Teach the child how to use the vehicle properly for safe and enjoyable driving.
- The toy must be used with caution, as it requires substantial dexterity in order to avoid falls or collisions which could cause injuries to the user or third parties.
- Before starting, check that there are no people or objects obstructing the vehicle's path.
- Drive with hands on the handlebars/steering wheel and always watch the road ahead.
- Brake in good time to avoid collisions.

ATTENTION!

The item is equipped with a brake system which needs to be appropriately illustrated to the child by an adult.

2nd GEAR (if present)

Initially, use in 1st gear is recommended. Before enabling 2nd gear, check that the child has learned to use the handlebars/steering wheel, 1st gear and the brake correctly, and has become familiar with the vehicle.

WARNING: IN ORDER TO AVOID THE RISK OF THE VEHICLE OVERTURNING ON BENDS, IT IS RECOMMENDED THAT YOU DO NOT USE HIGH SPEEDS (2nd gear) WHEN THE STABILISING WHEELS ARE FITTED.

WARNING!

- Check that all the wheel fixing studs/nuts are fastened properly.
- If the vehicle is overloaded, as can happen on soft sand, mud, or very uneven ground, the overload switch will immediately disconnect the power. The power supply will be restored after a few seconds.

UNINTERRUPTED FUN: Keep a spare set of charged batteries ready for use.

PROBLEMS?

THE VEHICLE DOES NOT WORK?

- Check that the battery is connected to the electrical system.
- Check the operation of the accelerator button and replace it if necessary.

THE VEHICLE LACKS POWER?

- Charge the batteries. If after charging the problem persists, have the battery and charger checked by an assistance centre.

ASSISTANCE SERVICE

PEG PEREGO offers an after-sales assistance service, directly or through a network of authorized assistance centres, for any repairs or replacements and the sale of original spare parts.

To contact a service center, visit our website:
<http://global.pegperego.com/toys-site/support/>

The item's serial number must always be quoted. See the page on spare parts to find out how to identify the serial number.

ASSEMBLY INSTRUCTIONS

WARNING

ASSEMBLY MUST ONLY BE CARRIED OUT BY ADULTS. TAKE CARE WHEN REMOVING THE VEHICLE FROM ITS PACKAGING. ALL THE SCREWS AND SMALL PARTS ARE CONTAINED IN A BAG INSIDE THE PACKAGING. THE BATTERY MAY ALREADY BE FITTED INSIDE THE ITEM.

Do not use the toy if you find it damaged after opening the packaging. Contact the shop where you bought it or the customer support centre.

Take care in the presence of children while assembling the toy, given the risks caused by small parts (ingestion hazard) and the plastic bags that contain them (choking hazard).

To assemble the toy, you will need a flat-head screwdriver, a Phillips screwdriver, a hammer, and a pair of pliers.

ASSEMBLY

- 1 • Lower the stand to support the motorbike while assembling it.
- 2 • Place the dashboard on the fork of the handlebars.
- 3 • Attach the dashboard with a screw.
- 4 • Pull out the handlebars as shown in the figure.
- 5 • Place the handlebars on the fork.
- 6 • Attach the handlebars with two screws.
- 7 • Press the two caps into place. PLEASE NOTE: The two caps are different. The one with the letter A on it goes on the left.
- 8 • Place the windshield on the fairing. Push in the sides (1) to help it fit in more easily (2).
- 9 • Fasten the windshield to the fairing with two screws.
- 10 • Place the fairing on the motorbike, pressing on the sides to fit it inside the bodywork. Make sure the slots in the central part of the fairing fit on properly.
- 11 • Attach the fairing to the bodywork with four screws (two on each side).
- 12 • Tighten the screw on the bottom.
- 13 • Connect the battery plug to the electrical system plug.
- 14 • Place the tail support on the rear of the motorbike.
- 15 • Attach the tail support with the four screws provided.
- 16 • Insert the metal tube in one half of the tail.
- 17 • Lift up the tank slightly and position the half of the tail with the metal tube as shown in the figure.
- 18 • Fasten the half of the tail to the frame of the motorbike with two screws.
- 19 • Insert the exhaust pipe into the rear slots on the half of the tail, as shown in the circles. Press at point A to complete the attachment process.
- 20 • Slightly lift the tank and put the other half of the tail into place. Ensure that it is correctly attached in the points shown in figures 21 and 22.
- 21 • Attach the front part of the other half of the tail to the metal tube at point A and to the frame at point B.
- 22 • Attach the rear part of the second half of the tail to the exhaust pipe at point C while ensuring that it fits onto the points marked with the letter D correctly.
- 23 • Attach the second half of the tail to the frame of the motorbike with two screws.
- 24 • Attach the tank to the bodywork by inserting the four tabs into the points indicated (two on each side).
- 25 • Attach the two parts of the tail to each other with the screw, as shown in the figure.
- 26 • Complete the tail attachment process by inserting a screw in the rear part.
- 27 • Position the saddle as shown in the figure.
- 28 • Secure the saddle by turning the lock to the position shown in diagram B. If the lock is

positioned as shown in diagram A, the saddle may be loose.

- 29 • Snap-fit the back rest.
- 30 • Position the cover on the rear part of the tail.
- 31 • Fasten down the tail cover with the screw provided.
- 32 • Position the footrest on the rear part of the motorbike.
- 33 • Attach the footrest to the frame with the screw. Repeat for the other footrest.

INSERTING THE BATTERIES

- 34 • Remove the screw on the dashboard and remove the cover.
- 35 • Remove the battery holder. Insert two 1.5V AA batteries, making sure they are positioned correctly.
 - Put the battery holder back inside the dashboard and secure the cover with the screw.

FEATURES AND USE OF THE VEHICLE

- 36 • DASHBOARD WITH SOUND EFFECTS: Press the buttons to hear the sound effects.
 - A: Horn
 - B: Roaring DUCATI engine
- 37 • HANDLEBARS:
 - Accelerator: Twist the grip downwards to set the motorbike into motion. The motorbike decelerates when the grip is turned upwards.
- 38 • SECOND SPEED SETTING: When the vehicle is removed from its packaging, it will be at the lower speed setting (FIRST SPEED SETTING) to allow the child to get used to the motorbike. To make the vehicle go faster (SECOND SPEED SETTING), raise the tank and press the button under the saddle. WARNING: In order to avoid the risk of the vehicle overturning on bends, it is recommended that you do not use high speeds (2nd gear) when the stabilising wheels are fitted.
- 39 • BRAKE PEDAL: To brake, push down on the pedal with a foot.
- 40 • STAND: Use when the motorbike is not fitted with stabilizers.
- 41 • STABILIZERS: Use if the child does not have a good sense of balance. WARNING: In order to avoid the risk of the vehicle overturning on bends, it is recommended that you do not use high speeds (2nd gear) when the stabilising wheels are fitted. To fit the stabilizers, follow the instructions for figures 42 - 46.
- 42 • To fit the stabilizers, loosen the locking nut on the rear wheel with the spanner provided. Remove the nut and washer and keep them for attaching the stabilizers.
- 43 • Remove the spacer and store it for use in the future, when the child will ride the motorbike without stabilizers.
- 44 • Insert the stabilizer on the wheel axle.
- 45 • Add the washer that was removed previously.
- 46 • Screw the locking nut back on. Repeat on the other side to fit the other stabilizer.

REPLACING THE BATTERY

- 47 • To replace a flat battery, turn the lock on the saddle to position A. Remove the saddle.
- 48 • Undo the two screws on the battery holder and remove it.
- 49 • Disconnect the battery plug from the electrical system plug.
- 50 • Replace the battery and reconnect the plugs.
- 51 • Put the battery holder back into position, passing it under the battery handle.
- 52 • Fasten down the battery holder with the two screws, replace the saddle and secure it by turning the lock. WARNING: Always secure the battery holder and the saddle before using the motorbike.

CHARGING THE BATTERY

WARNING: BATTERY CHARGING AND ANY OTHER WORK ON THE ELECTRICAL SYSTEM MUST BE CARRIED OUT BY ADULTS. THE BATTERY CAN ALSO BE CHARGED WITHOUT REMOVING IT FROM THE TOY.

- 53 • Disconnect plug A of the electrical system from the battery plug B by pressing the sides of the plugs.
- 54 • Connect the battery charger plug to a domestic power supply in accordance with the instructions supplied with the battery charger. Connect plug B of the battery with plug C of the battery charger.
- 55 • When charging is complete, detach the battery charger from the domestic socket and then disconnect plug C from plug B.
- 56 • Fully insert plug B into plug A, ensuring that they click together.

- WARNING: Once the battery is recharged, always secure the saddle by turning the lock.
- 57 • The battery can also be charged outside the vehicle. This means that if you have a spare battery, the child can continue to play.